

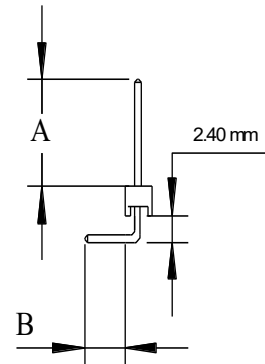

WINSLOW ADAPTICS

Data Sheet – 0.64mm Square Post Un-shrouded Header W819 Series

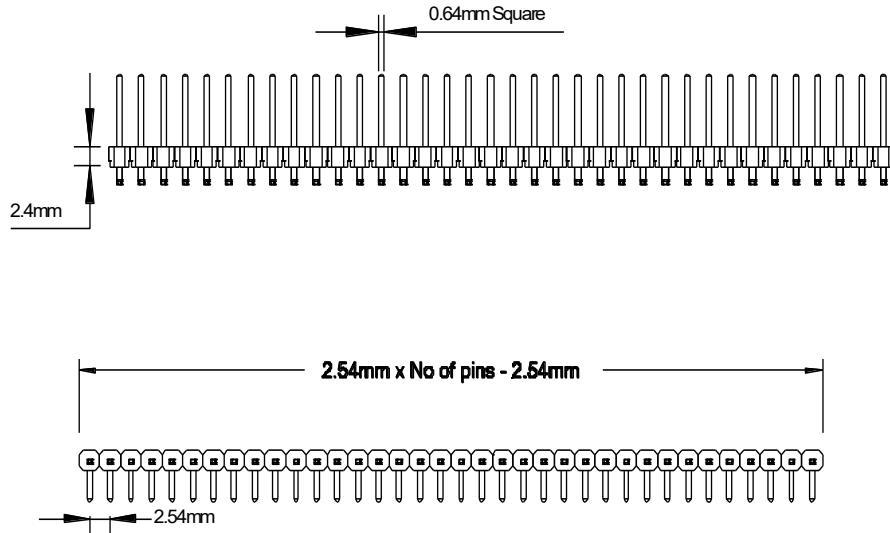

W819

Series

XX

No of Pins

X

T - Tin
G - Gold

XX

t38xxRC - RoHS compliant Tin
G03 - RoHS complaint Au

XX

Dimensions

Suffix	Dimension A	Dimension B
34	4.80mm	5.11mm
03	5.70mm	2.50mm
04	5.72mm	5.10mm
22	5.80mm	3.40mm
21	6.70mm	3.20mm
20	7.00mm	2.90mm
25	7.00mm	3.00mm
31	7.40mm	2.54mm
19	8.00mm	2.80mm
36	9.70mm	5.84mm
33	12.50mm	2.54mm
32	13.00mm	2.54mm



Data Sheet – 0.64mm Square Post Un-shrouded Header W819 Series

General Specifications

Unless stated all values are typical.

Contact

Resistance: 20m Ω Max
 Current Rating: 1A max.
 Dielectric Withstanding Voltage: AC 650 Volts RMS at Sea Level
 Material: Half Hard Brass.
 Plating: 6.0 microns pure bright tin over 2.5 microns nickel.

Moulding

Material: 30% Glass Fibre-Reinforced Polyester (Polybutylene Terephthalate - PBT)
 Insulation Resistance: 5000 M Ω (contact to contact) at 500VDC
 Arc Resistance: 145 seconds at 23C
 Electrical Strength: 121KV/cm at 23C
 Dielectric Constant: 3.9 (48 hrs 90%RH) at 100Hz 23C
 4.5 at 100Hz 121 degrees C
 3.7 (48 hrs 90%RH) at 1MHz 23C
 4.3 at 1MHz 121C
 Dissipation Factor: 0.0077 (48 hrs 30%RH) at 100Hz 23C
 0.0300 at 100Hz 121C
 0.0150 (48 hrs 30%RH) at 1MHz 23C
 0.0200 at 1MHz 121C
 Volume Resistivity: 3 x 10¹³ohms-CM (48 hrs 90%RH) at 25C
 10¹³ Ω -CM at 121C
 Operating Temperature: -65C to 150C
 Flammability: UL94V-0



Also available from Winslow Adaptics are cost effective, time saving solutions to test, obsolescence, supply problems and upgrades. OEMs can upgrade equipment with custom Adaptics utilising additional logic, often saving considerable cost and time on re-design. If lead-time becomes an issue contact us for a suitable package converter. We specialise in conversion of all package lead-frames. For further information please contact your nearest sales office