

WINSLOW ADAPTICs

Data Sheet – Multi Link W8040X SERIES

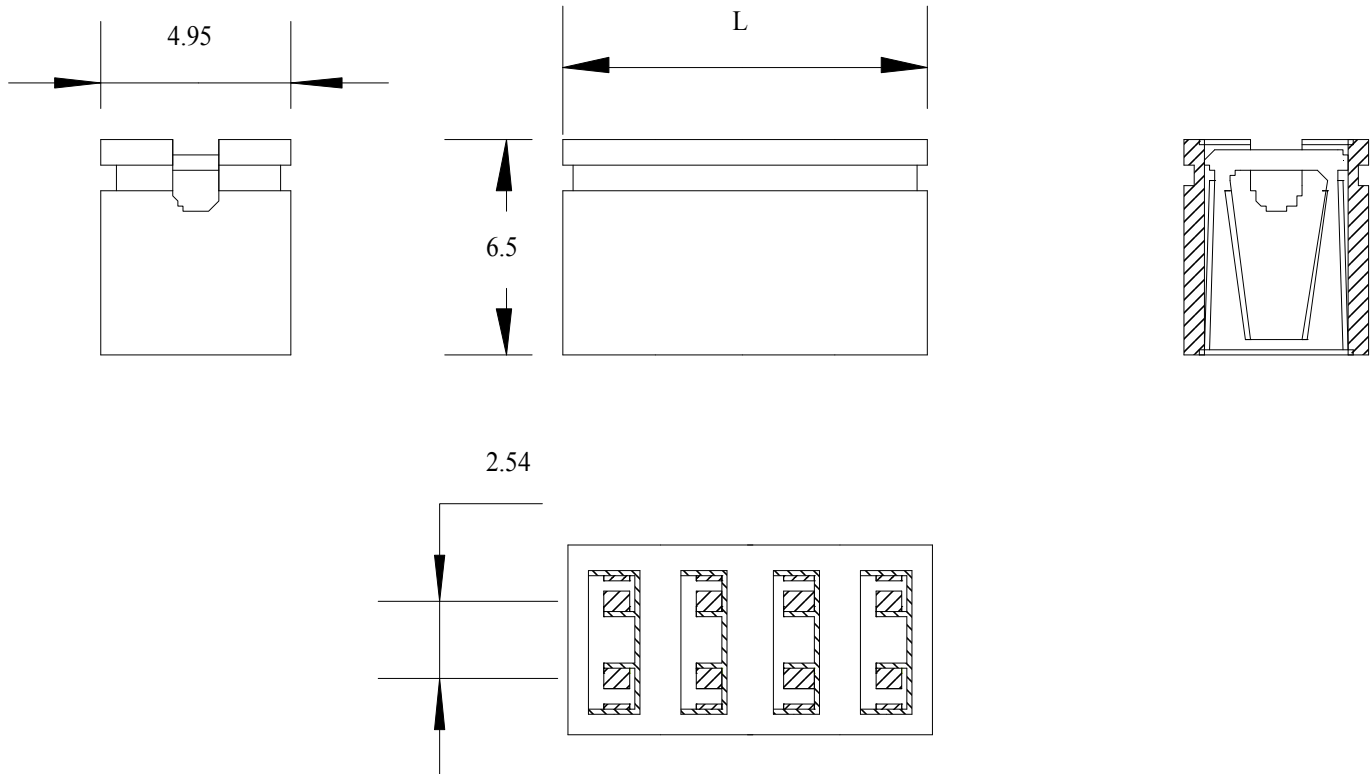

Part Number	No of Ways	Length (L)
W8042x	2	2 x 2.54mm
W8043x	3	3 x 2.54mm
W8044x	4	4 x 2.54mm
W8045x	5	5 x 2.54mm
W8046x	6	6 x 2.54mm
W8047x	7	7 x 2.54mm
W8048x	8	8 x 2.54mm
W8049x	9	9 x 2.54mm

Suffix

TRC - RoHS Tin
G - Gold

WINSLOW ADAPTICS

Data Sheet – Multi Link W8043TRC

General Specifications

Unless stated all values are typical.

Contact

Resistance: 30M ohms max
Current Rating: 3 amp max.
Dielectric Withstanding Voltage: AC 650 Volts RMS at Sea Level

Material: Phosphor Bronze

Plating: Pure Tin 6.0um over Nickel 2.5um

Moulding

Material: Glass-reinforced Polyester (PBT)
Insulation Resistance: 1010 Ohms (contact to contact) at 500VDC
Arc Resistance: 145 seconds at 23 degrees C
Electrical Strength: 121KV/cm at 23 degrees C
Dielectric Constant: 3.9 (48 hrs 90%RH) at 100Hz 23 degrees C
4.5 at 100Hz 121 degrees C
3.7 (48 hrs 90%RH) at 1MHz 23 degrees C
4.3 at 1MHz 121 degrees C
Dissipation Factor: 0.0077 (48 hrs 30%RH) at 100Hz 23 degrees C
0.0300 at 100Hz 121 degrees C
0.0150 (48 hrs 30%RH) at 1MHz 23 degrees C
0.0200 at 1MHz 121 degrees C
Volume Resistivity: 3 x 1013ohms-CM (48 hrs 90%RH) at 25 degrees C
1013ohms-CM at 121 degrees C
Operating Temperature: -65 to 150 degrees C
Flammability: UL94V-0



Also available from Winslow Adaptics are cost effective, time saving solutions to test, obsolescence, supply problems and upgrades. OEMs can upgrade equipment with custom Adaptics utilising additional logic, often saving considerable cost and time on re-design. If lead-time becomes an issue contact us for a suitable package converter. We specialise in conversion of all package lead-frames. For further information please contact your nearest sales office